

## Exclusive Property Investment in the Piemonte region of Italy- Near Barbaresco

**Reference: 6557 - Price: €280,000.**

Property categories : [Apartment](#) : [Business potential](#) : [Farmhouse and country house](#) : [Ready to move into](#) : [Vineyard](#)



This property represents an interesting investment with excellent vacation rental opportunity to high net worth clients seeking luxury accommodation and spa facilities in one of the most important areas of the Langhe close to Barbaresco & Alba.

**Area:** Cuneo: The Langhe **Parking:** Yes garage underground

**Land size:** 5000 sqm **Services:** All services connected

**Condition:** Newly Restored

### Location

In the heart of the famous Barbaresco vineyards.... Nearby towns boast medieval buildings, baroque towers and small cobbled streets all surrounded by spectacular scenery overlooking the Barbaresco vineyards & mountain range. The apartments are walking distance from the town which has a excellent infrastructure with fresh pasta shops, butcher, bakers, home made ice cream, bars, restaurants and of course a wine shops/enoteca.... Less than 15 minutes to the important town of Alba famous amongst many things for its medieval towers and tartufu..

## Property Description

This exclusive small residence enjoys the most amazing location overlooking the old medieval town of Neive, the prestigious Barbaresco vineyards.

The architectural design of the residence has paid particular attention to ensure every property has uninterrupted views and designed to compliment the natural slope of the hill with architecture respecting local tradition and materials such as Langhe stone, Coppi roof tiles and old bricks...

The exclusive residence consists of two buildings finished in traditional Langhe stone and immersed within the charm, nature and ambience of the Langhe area.

There is a choice of 12 apartments with varying sizes. The complex will be a newly restored/constructed combining modern construction techniques and energy efficiency while respecting the original character and using only traditional and local building materials.

Internal plans of each property have been carefully designed to maximize use of space and the ambience of this very special location.

Internal designs can be adapted to accommodate individual requirements if required.

The land surrounding the complex is more than 5000 sqm including its very own DOCG vineyard.

The residence includes a Health Spa exclusively for residents including an Infinity swimming pool, sauna, gymnasium, Jacuzzi and Turkish bath.

The architectural attention to detail and unique picturesque position make this an elegant and quality residence.

A truly rare investment opportunity perfectly located to enjoy the nearby cities of Turin, Milan and Genoa, The Italian Riviera, The Mountains and Italian Lakes

Prices from Euro 225000

E- mail for further information

## Property photos

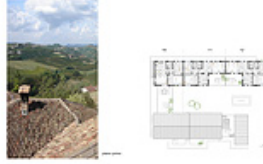
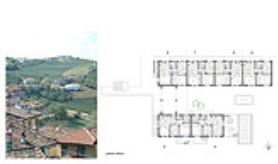

[PiedmontProperty.com](http://PiedmontProperty.com) - [client.info@piedmontproperty.com](mailto:client.info@piedmontproperty.com) - Tel: 0039 0173 529277 / 0039 3337464121